



Inglebys

Estate Agents



9 William Street

New Skelton, TS12 2AG

£85,000



Recently Modernised to a high standard, this 3 bedroom property has ample curb appeal with modern grey windows and crisp render. Internally a log burning stove creates a cosy living room and a raised terrace adds sweeping views to the rear.



Greatly improved by the current owners, this mid terrace property offers spacious living accommodation with 3 bedrooms + Cellar as well as a roof top terrace with views over the surrounding area.

Log burner & 2 year old boiler combi boiler alongside recently installed double glazing will create a cosy home.

Tenure Details: Freehold

Council Tax Band: A

EPC Rating: D

Entrance Hall 13'9" x 3'2" (4.21 x 0.99)

Carpeted, radiator, composite front door, central heating thermostat, smoke alarm, electric meter, fuse board.

Lounge/ Dining 22'5" x 12'4" (6.85 x 3.77)

Carpeted, log burner, UPVC double glazed bay window, 2x radiators, virgin point, TV point, cupboard housing combi boiler (2 years old), door leading to basement.

Kitchen 7'7" x 8'5" (2.32 x 2.59)

Range of wall base and drawer units, 1 + half sink & drainer, plumbed for washing machine, integrated electric oven + hob.

Inner Hallway 2'8" x 6'6" (0.82 x 1.99)

UPVC double glazed door leading to the rear yard.

Bathroom 3'10" x 7'8" (1.19 x 2.35)

Panel bath with electric shower over, toilet, pedestal wash hand basin, UPVC double glazed window.

Landing 11'5" x 6'3" (3.49 x 1.92)

Carpeted, UPVC double glazed door leading to roof terrace, smoke alarm, ventilation system, storage cupboard.

Bedroom 1 11'7" x 9'8" (3.54 x 2.97)

UPVC double glazed window, radiator.

Bedroom 2 10'5" x 9'4" (3.18 x 2.86)

UPVC double glazed window, radiator.

Bedroom 3 10'6" x 6'7" (3.21 x 2.02)

UPVC double glazed window, radiator.

Cellar 11'1" x 17'2" (3.38 x 5.24)

Radiator, UPVC double glazed door leading to yard.

Area Map



Floor Plans

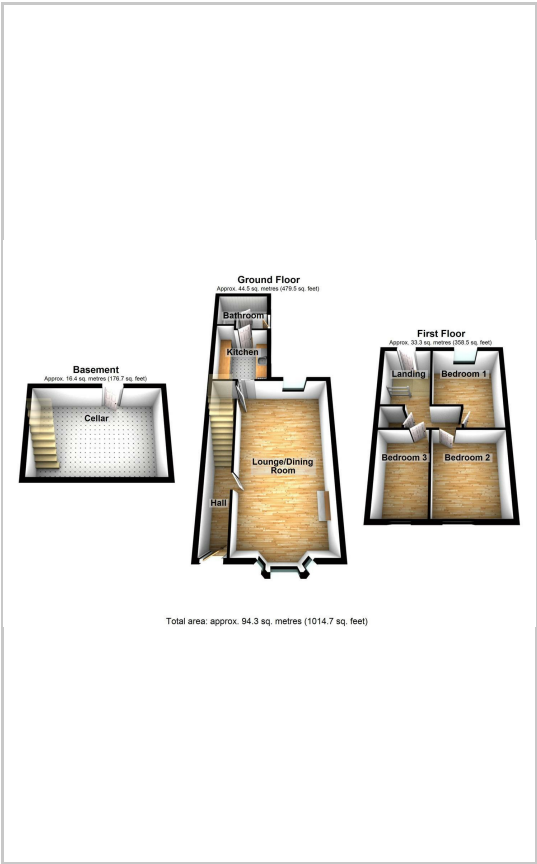

Energy Efficiency Graph

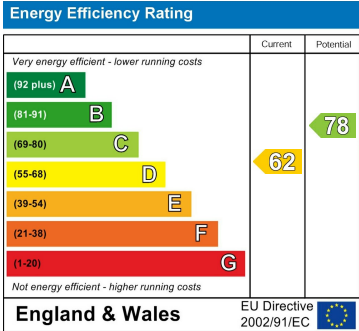

These particulars, whilst believed to be accurate are set out as a general outline only for guidance and do not constitute any part of an offer or contract. Intending purchasers should not rely on them as statements of representation of fact, but must satisfy themselves by inspection or otherwise as to their accuracy. No person in this firms employment has the authority to make or give any representation or warranty in respect of the property.